

# MALDIVES LAND AND SURVEY AUTHORITY

MINISTRY OF HOUSING AND INFRASTRUCTURE

Office (PABX): +(960) 3004300, Fax: +(960) 3004254

Ameenee Magu, Maafannu, Male', 20392, Maldives.

Email: survey@housing.gov.mv

Web: www.surveyofmaldives.gov.mv



CONTROL POINT DETAILS		Station Number	PSM0705
Coordinate Information			
Geodetic		Grid	
WGS 84		UTM Zone 43	
Lat:	3° 50' 25.91856" N	E:	319,723.0150 m
Long:	73° 22' 35.36771" E	N:	424,671.7700 m
Ellp. Height:	-95.3917 m	Orth Height:	1.1500 m
Island Name: K.Tholhimarahuraa (LD1329)		Date:	17 – 03 - 2025

## Monument description & method of survey:

- Concrete casted in situ to a dimeter 0.3m HDPE pipe, 1m length, 1.5m s/s rod driven to ground as the center with cross mark. Monument labeled with s/s plate stating the point ID.
- Above 150mm from the existing ground level.
- GNSS Static Survey Precise Point Positioning (PPP) post processing.
- Elevation reduced relative to local MSL by reference to Hulhule' tide prediction data.
- Inter- visible with PSM0706.

## General site condition & access:

- Easily accessible area with wide angle of sky visibility.

## Owner:

Prime Atoll Maldives Pvt Ltd.



DOWN TOWARD PSM



NORTH VIEW



EAST VIEW



FROM PSM UPTOWARD SKY



SOUTH VIEW



WEST VIEW

# SITE INFORMATION

Station Number

P S M 0 7 0 5

Station Horizon Mask 330

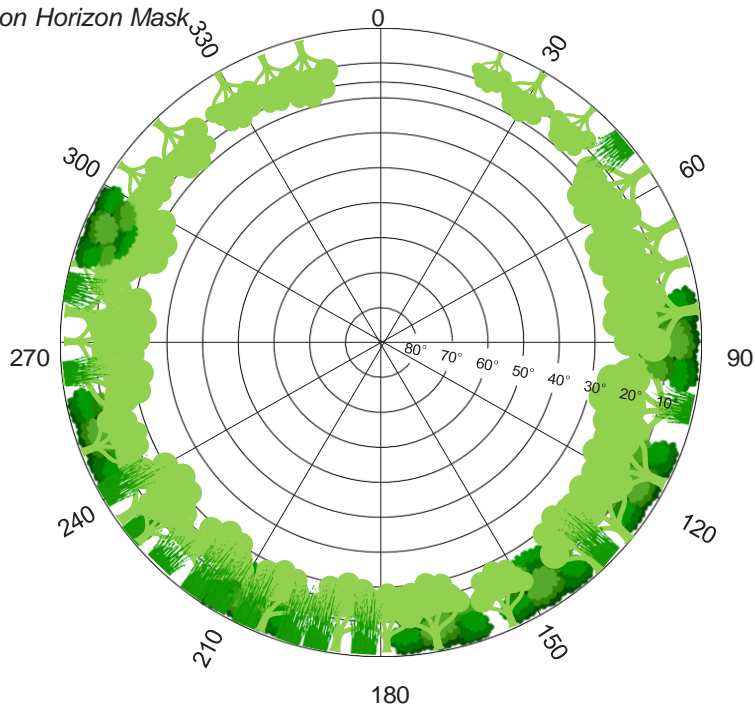

Height above Marker that horizon was mapped from 1.5 m

Magnetic Declination -----  
Declination applied to this figure?  
☐ Yes ☒ No

Locality

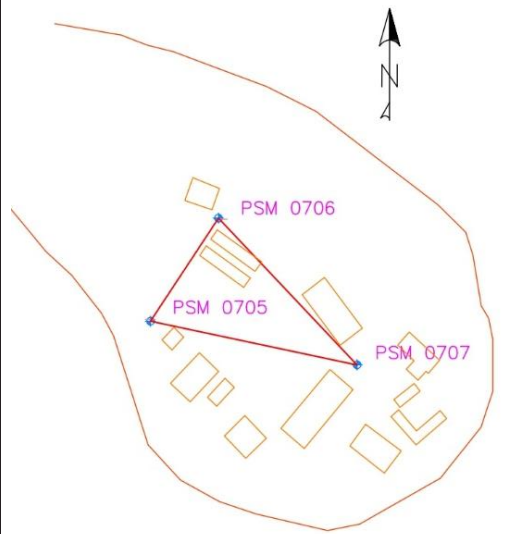

Sketched by: Indula Karunathilaka

Scale: 1:75

Date: 09/04/2025

**Maldives Land and Survey Authority**, MINISTRY OF HOUSING AND INFRASTRUCTURE, Ameenee Magu, Maafannu, Male', 20392, Maldives,  
Office (PABX): +(960) 3004300, Fax: +(960) 3004254, Email: [survey@housing.gov.mv](mailto:survey@housing.gov.mv), Web: [www.surveyofmaldives.gov.mv](http://www.surveyofmaldives.gov.mv)

# MALDIVES LAND AND SURVEY AUTHORITY

MINISTRY OF HOUSING AND INFRASTRUCTURE

Office (PABX): +(960) 3004300, Fax: +(960) 3004254

Ameenee Magu, Maafannu, Male', 20392, Maldives.

Email: survey@housing.gov.mv

Web: www.surveyofmaldives.gov.mv



CONTROL POINT DETAILS		Station Number	PSM0706
Coordinate Information			
Geodetic		Grid	
WGS 84		UTM Zone 43	
Lat:	3° 50' 26.66853" N	E:	319,738.4689 m
Long:	73° 22' 35.86718" E	N:	424,694.7773 m
Ellp Height:	- 95.4918	Orth Height:	1.0500 m
Island Name: K.Tholhimarahuraa (LD1329)		Date:	17 – 03 - 2025

## Monument description & method of survey:

- Concrete casted in situ to a diameter 0.3m HDPE pipe, 1m length, 1.5m s/s rod driven to ground as the center with cross mark. Monument labeled with s/s plate stating the point ID.
- Above 150mm from the existing ground level.
- GNSS static survey post processing with 3D Minimally Constrained Network Adjustment.
- Reduce level of PSM 0705 was transferred to PSM0706 by using the level difference obtained from the GNSS Static Survey and EGM 2008 Geoid.
- PSM 0705 and PSM 0706 are inter visible.

## General site condition & access:

- Easily accessible area with wide angle of sky visibility.

## Owner:

Prime Atoll Maldives Pvt Ltd.



DOWN TOWARD PSM

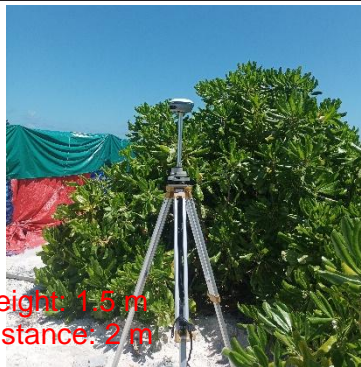

Height: 1.5 m  
Distance: 2 m

NORTH VIEW



Height: 1.5 m  
Distance: 2 m

EAST VIEW

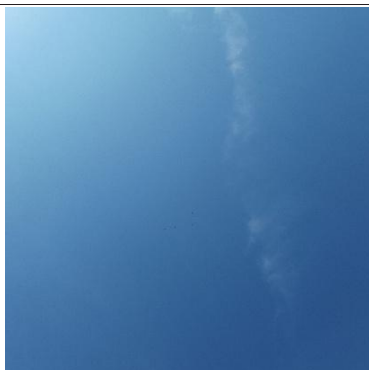

FROM PSM UPTOWARD SKY



Height: 1.5 m  
Distance: 2 m

SOUTH VIEW



Height: 1.5 m  
Distance: 2 m

WEST VIEW

## SITE INFORMATION

Station Number

P	S	M	0	7	0	6
---	---	---	---	---	---	---

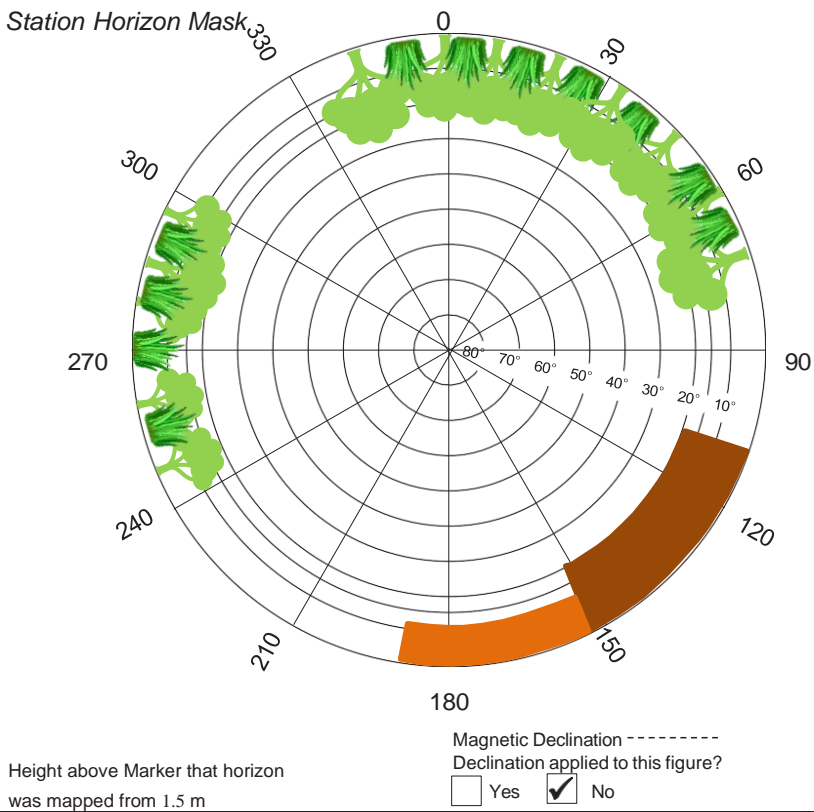

### Locality

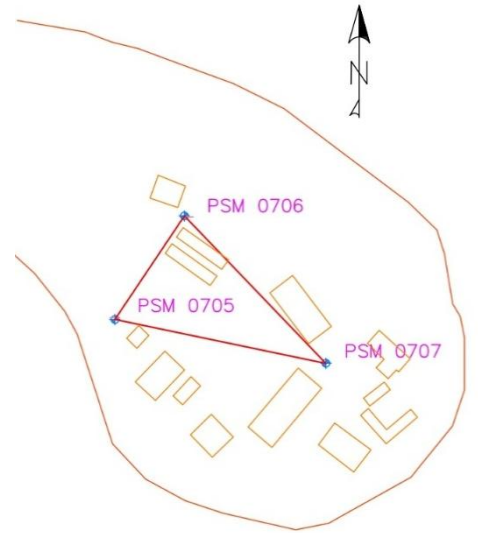

Sketched by: Indula Karunathilaka

Scale: 1:75

Date: 09/04/2025

**Maldives Land and Survey Authority**, MINISTRY OF HOUSING AND INFRASTRUCTURE, Ameenee Magu, Maafannu, Male', 20392, Maldives,  
Office (PABX): +(960) 3004300, Fax: +(960) 3004254, Email: [survey@housing.gov.mv](mailto:survey@housing.gov.mv), Web: [www.surveyofmaldives.gov.mv](http://www.surveyofmaldives.gov.mv)

# MALDIVES LAND AND SURVEY AUTHORITY

MINISTRY OF HOUSING AND INFRASTRUCTURE

Office (PABX): +(960) 3004300, Fax: +(960) 3004254

Ameenee Magu, Maafannu, Male', 20392, Maldives.

Email: survey@housing.gov.mv

Web: www.surveyofmaldives.gov.mv



CONTROL POINT DETAILS		Station Number	PSM0707
Coordinate Information			
Geodetic		Grid	
WGS 84		UTM Zone 43	
Lat:	3° 50' 25.60501" N	E:	319,769.9090 m
Long:	73° 22' 36.88821" E	N:	424,662.0500 m
Ellp Height:	- 95.5402 m	Orth Height:	1.0027 m
Island Name: K.Tholhimarahuraa (LD1329)		Date:	17 – 03 - 2025

## Monument description & method of survey:

- Concrete casted in situ to a diameter 0.3m HDPE pipe, 1m length, 1.5m s/s rod driven to ground as the center with cross mark. Monument labeled with s/s plate stating the point ID.
- Above 150mm from the existing ground level.
- GNSS static survey post processing with 3D Minimally Constrained Network Adjustment.
- Reduce level of PSM 0705 was transferred to PSM0707 by using the level difference obtained from the GNSS Static Survey and EGM 2008 Geoid.

## General site condition & access:

- Easily accessible area with wide angle of sky visibility.
- Located near the main office building.

## Owner:

Prime Atoll Maldives Pvt Ltd.



DOWN TOWARD PSM



Height: 1.5 m  
Distance: 2 m

NORTH VIEW



Height: 1.5 m  
Distance: 2 m

EAST VIEW

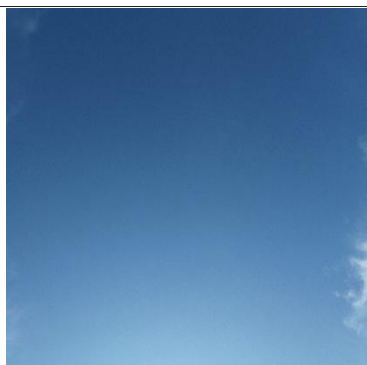

FROM PSM UPTOWARD SKY



Height: 1.5 m  
Distance: 2 m

SOUTH VIEW

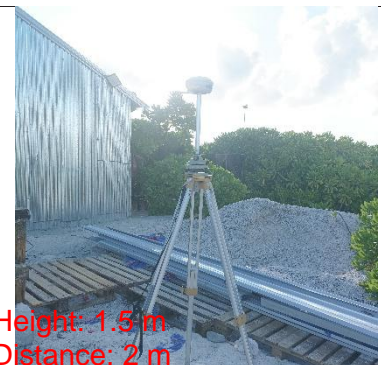

Height: 1.5 m  
Distance: 2 m

WEST VIEW

# SITE INFORMATION

Station Number

P S M 0 7 0 7

Station Horizon Mask 330

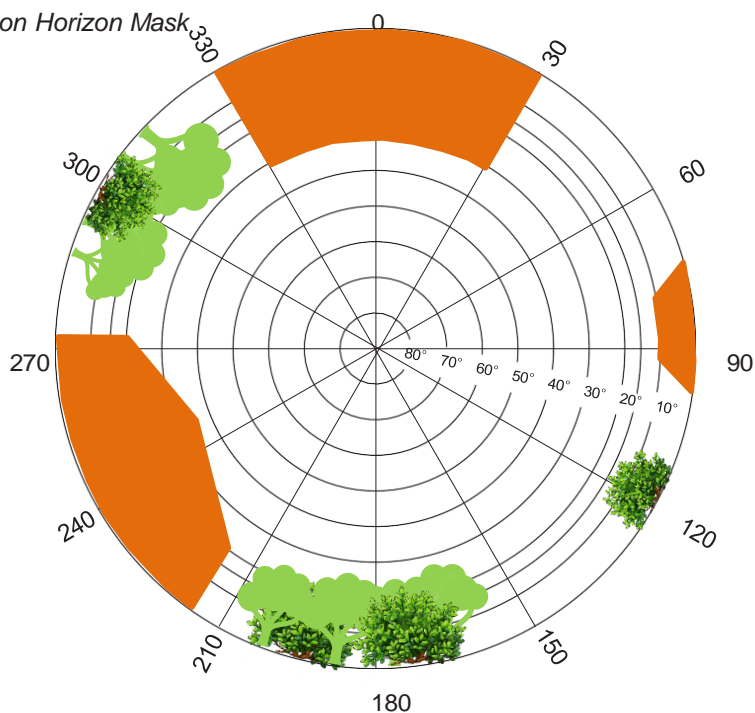

Height above Marker that horizon was mapped from 1.5 m

Magnetic Declination -----  
Declination applied to this figure?  
☐ Yes ☒ No

Locality

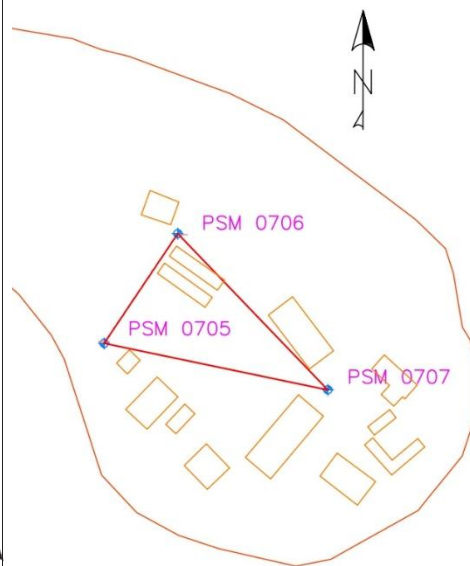

Sketched by: Indula Karunathilaka

Scale: 1:75

Date: 09/04/2025